

R Series Aluminum Alloy and Stainless Steel mini cylinder

R: Mini Type

A: standard cylinder
D: double-shaft type
J: double-shaft and adjustable stroke type
SA: spring extent
SB: spring return
AC: adjustable cushion type

L: aluminum barrel
S: stainless steel barrel

Blank: Swiveling tail
U: Flat tail
CM: Round tail

Bore x stroke
 16-63mm
 0-1000mm

Blank: No magnet
S: magnet

Fixed type:
 Blank: basic type
RLB type: front and back fixed type
RFA: front cover fixed type
RSDB: back cover swinging type

Product Features

- Lubrication-free
With self lubricating bearing, the lubrication of plunger rod is not needed.
- Buffer Performance
In addition to fixed buffer, the cylinder end is also provided with adjustable buffer, so that smooth changeover is ensured and no impact is caused.
- With magnetic element
A permanent magnet is mounted on the cylinder plunger, and it is used to actuate the magnetic switch mounted on the cylinder to detect the acting position of the cylinder.

Specifications

Cylinder Diameter(mm)	16	20	25	32	40	50	63	
Acting Mode	Double Acting							
Working Medium	Air							
Fixture type	Basic type RFA RSDB RLB			Basic type				
Range of working pressure (Kg/cm ²)	1 ~ 9.0							
Guaranteed withstanding pressure (Kg/cm ²)	13.5							
Range of working temperature (°C)	-5 ~ 70							
Speed range (mm/s)	50 ~ 800			50 ~ 800				
Buffer type	Standard Type	Anti-bump cushion					50 ~ 800	
	Cushion Type	Adjustable Buffer (Optional)						
Joint Size(mm)	M5 x 0.8	PT1/8			PT1/4			

RAL Fixing Dimensions

Φ20~Φ40

○ Model with swiveling tail

○ Model with round tail

○ Model with flat tail

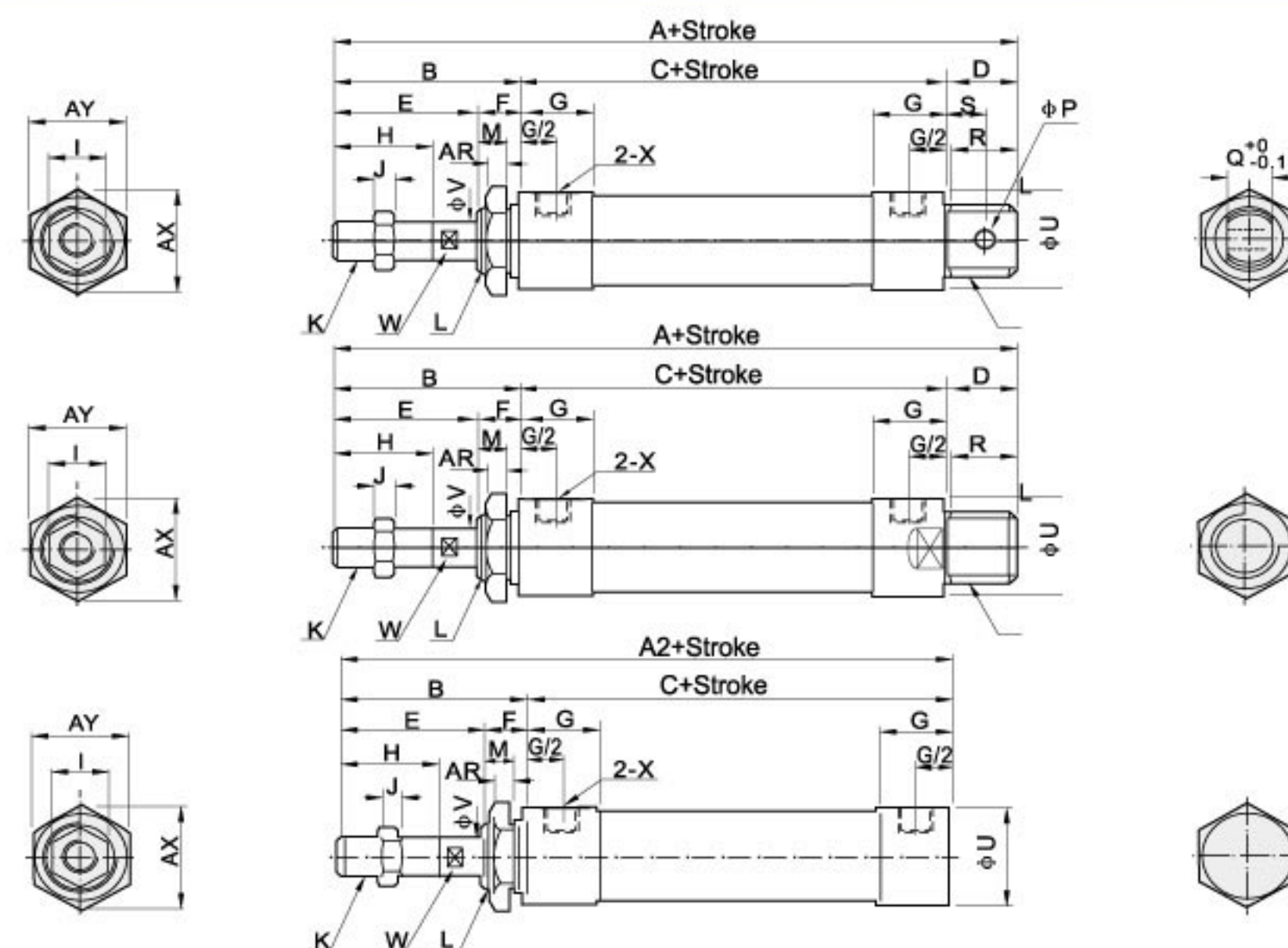

Diameter /Sign	A	A1	A2	B	C	D	D1	E	F	G	H	I	J	K
20	131	122	110	40	70	21	12	28	12	16	20	12	6	M8x1.25
25	135	128	114	44	70	21	14	30	14	16	22	17	6	M10x1.25
32	141	128	114	44	70	27	14	30	14	16	22	17	6	M10x1.25
40	165	152	138	46	92	27	14	32	14	22	24	17	7	M12x1.25

Diameter /Sign	L	M	P	Q	R	R1	S	U	V	W	X	AR	AX	AY
20	M22x1.5	10	8	16	19	10	12	29	8	6	PT1/8	7	33	29
25	M22x1.5	12	8	16	19	12	12	34	10	8	PT1/8	7	33	29
32	M24x2.0	12	10	16	25	12	15	39.5	12	10	PT1/8	8	37	32
40	M30x2.0	12	12	20	25	12	15	49.5	16	14	PT1/4	9	47	41

RAS Internal construction

○ No magnet

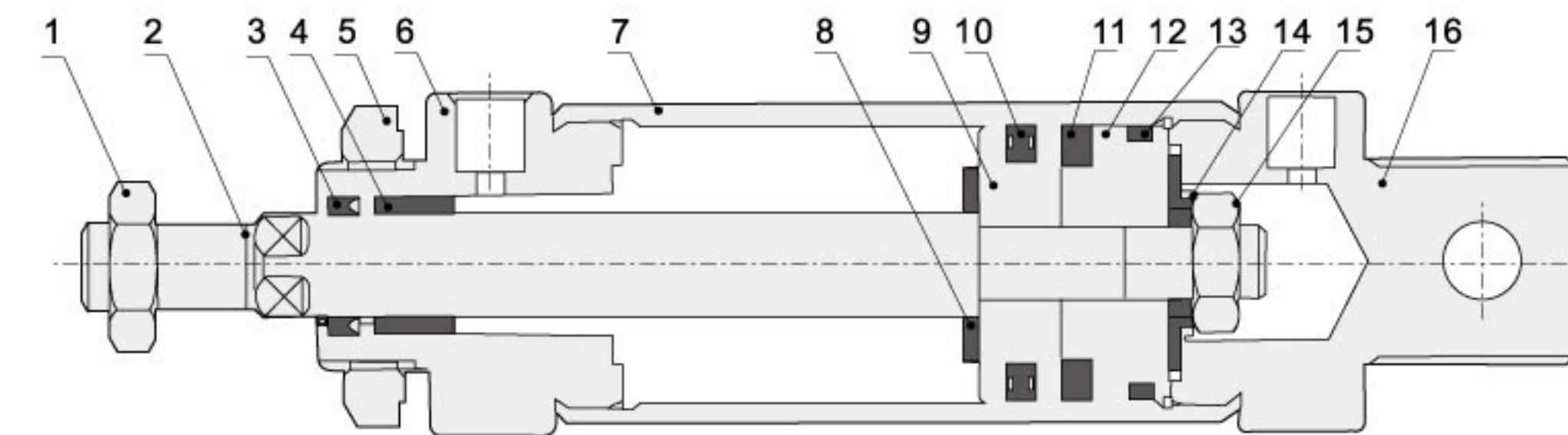

Item No.	Designation	Item No.	Designation
1	Piston Nut	2	Piston Rod
3	Head Cap Seal	4	Rod Bearing / Bushing
5	Piston Nut Head Cap	6	Head Cap
7	Stainless steel tube	8	Anti-bump cushion
9	Piston	10	O-Ring / Piston Seal
11	Magnet	12	Magnet Base
13	Wear Ring	14	后垫华司
15	Out Rexagen nut	16	End Cap

RAL Basic dimensions

Φ16~Φ40

○ Model with swiveling tail

○ Model with flat tail

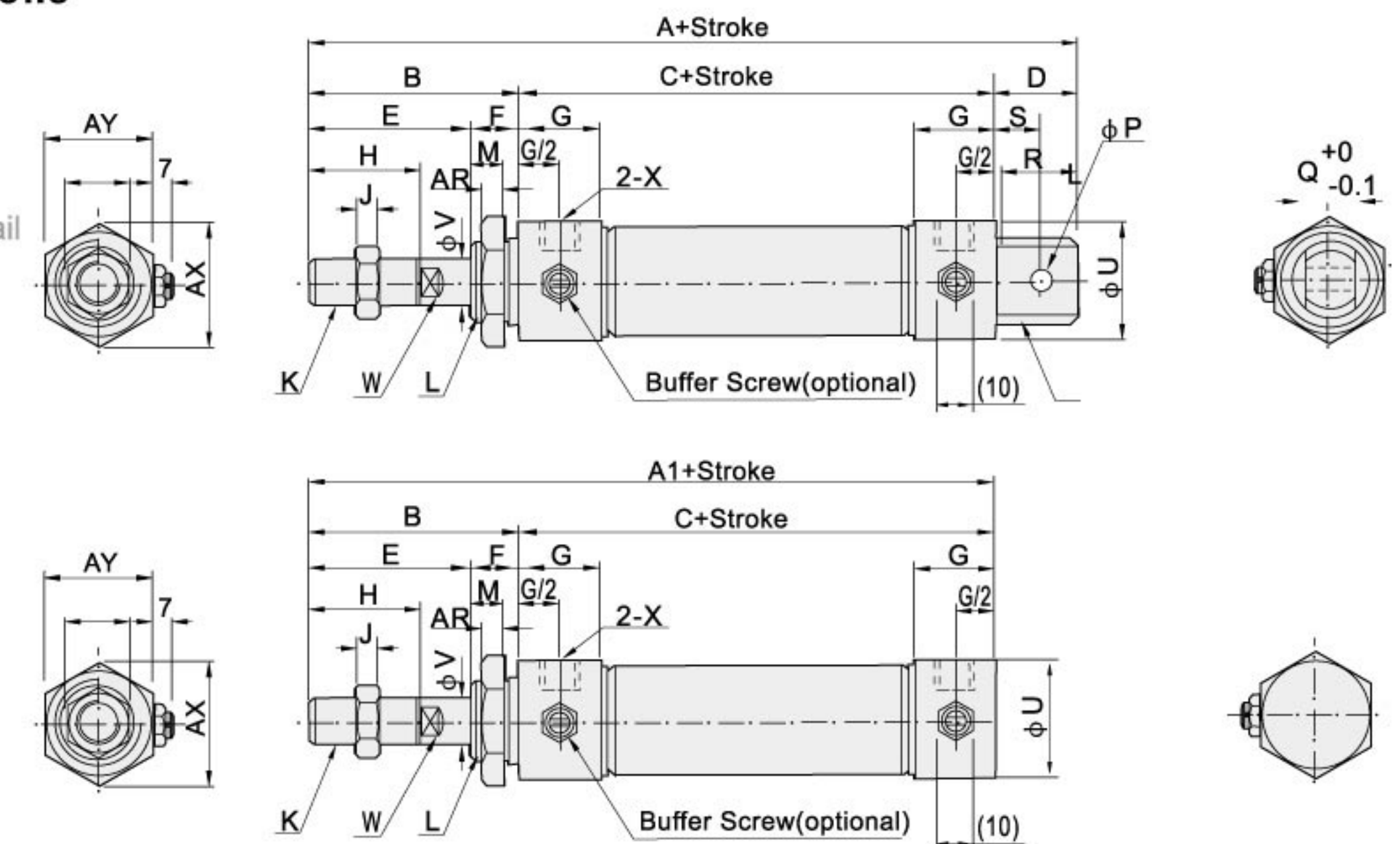

Diameter /Sign	A	A1	B	C	D	E	F	G	H	I	J	K
16 ※	114	98	38	60	16	22	16	10	16	10	5	M6x1
20	137	116	40	76	21	28	12	16	20	12	6	M8x1.25
25	141	120	44	76	21	30	14	16	22	17	6	M10x1.25
32	147	120	44	76	27	30	14	16	22	17	6	M10x1.25
40	149	122	46	76	27	32	14	16.7	24	17	7	M12x1.25

Diameter /Sign	L	M	P	Q	R	S	U	V	W	X	AR	AX	AY
16 ※	M16x1.5	14	6	12	14	9	21	6	5	M5	6	25	114
20	M22x1.5	10	8	16	19	12	27	8	6	PT1/8	7	33	137
25	M22x1.5	12	8	16	19	12	30	10	8	PT1/8	7	33	141
32	M24x2.0	12	10	16	25	15	35	12	10	PT1/8	8	37	147
40	M30x2.0	12	12	20	25	15	41.6	16	14	PT1/8	9	47	149

*There is to MAC impulse model for this type.